

Step up to adventure

Introducing the **new Nursery gym**



10-Year
Warranty

Nursery gyms

Young children learn through movement and play. Action is essential for their healthy development. The Nursery gym provides up-and-down and over-and-under activity as well as varied tactile experience. Its imaginative design fosters budding role play.

For ages 6 to 36 months.

Climb and crawl

Our smallest set welcomes babies just learning to navigate stairs and ramps.

Climb and crawl

blue carpet **G800 £736**

warm sand carpet **G805 £736**

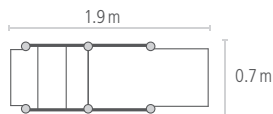

The palace

Our largest set provides everything from exercise to role play and caters to children of many ages.

The palace

blue carpet **G860 £2,535**

warm sand carpet **G865 £2,535**

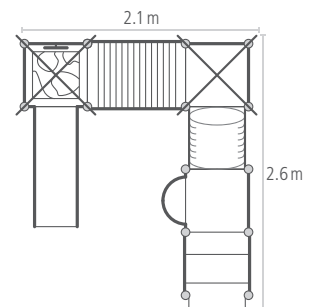

"Crossing an arched bridge is a challenge which young children repeat over and over. Once they have mastered that, there's a new challenge to discover."

David Paul

Community Playthings Design Engineer



**Tool-free
assembly**

Up and over

Is your room tight on space? With a ramp for babies, this gym will fit beautifully in the smallest room.

Up and over with roof
blue carpet **G802 £1,221**
warm sand carpet **G807 £1,221**

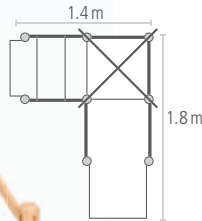

Up and over with balcony
blue carpet **G803 £1,016**
warm sand carpet **G808 £1,016**

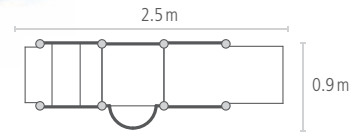

Up and over
blue carpet **G801 £966**
warm sand carpet **G806 £966**

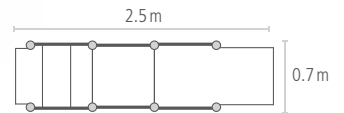

Climb and slide

These sets will be perfect if your children are ready for the challenge and excitement of a slide.

Climb and slide with balcony/roof
blue carpet **G812 £1,118**
warm sand carpet **G817 £1,118**

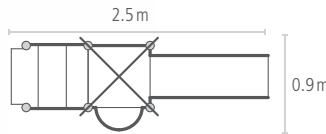

Climb and slide with roof
blue carpet **G811 £1,073**
warm sand carpet **G816 £1,073**

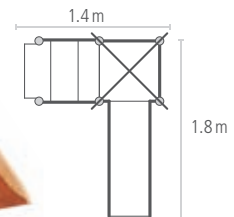

Climb and slide
blue carpet **G810 £823**
warm sand carpet **G815 £823**

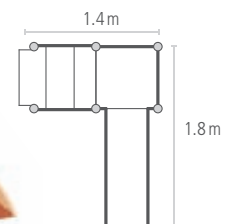

“Young children are drawn to the Juliet balcony. It gives them the experience of looking down on the action for once.”

Jeremy Hindley
Nursery gym design team



Made in the UK

Sand dune

Do you remember the first time you walked down a sandy beach? The terrain platform with its contoured foam surface provides the unpredictable surfaces found in nature.



Sand dune with slide
blue carpet **G820 £883**
warm sand carpet **G825 £883**

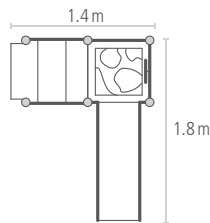

Sand dune with slide/ramp
blue carpet **G821 £1,126**
warm sand carpet **G826 £1,126**

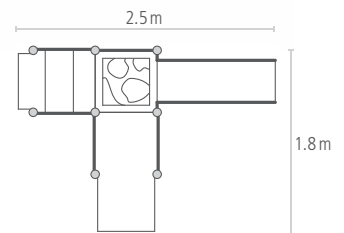

Rapunzel's tower

For children of differing ages, this compact gym has the basics for beginners as well as surprises for toddlers discovering the magic of role play.

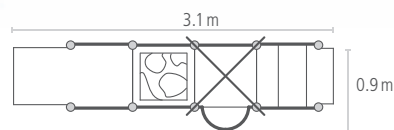

Rapunzel with ramp
blue carpet **G822 £1,521**
warm sand carpet **G827 £1,521**

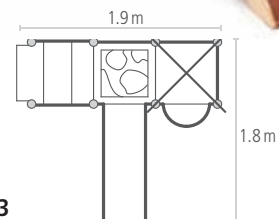

Rapunzel with slide
blue carpet **G823 £1,373**
warm sand carpet **G828 £1,373**

"Babies discover with their fingers and toes. They explore smooth and prickly, squishy and soft. I challenged Community's design team to provide varying textures and uneven surfaces."

Jan White

Outdoor play consultant



Billy goat's bridge

The arched bridge is an adventure in itself. Walk over the bridge or crawl through the tunnel underneath. Of course the view from the top makes little people feel really big!



Every slide comes with a gate. This extra gate will close off a ramp or stairs. See the back cover to order.



Billy goat's bridge with slide
blue carpet **G830 £1,205**
warm sand carpet **G835 £1,205**

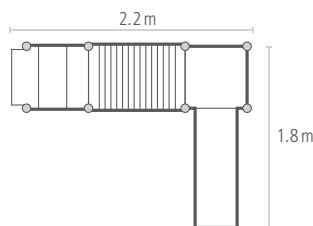

Billy goat's bridge with ramp
blue carpet **G831 £1,353**
warm sand carpet **G836 £1,353**

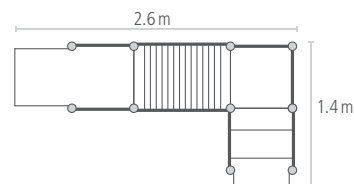

Knightsbridge

Knights and ladies – climb over the moat and off to meet the dragon. When you choose the model with the balcony, you can be a ship's captain.



Knightsbridge
blue carpet **G832 £1,695**
warm sand carpet **G837 £1,695**

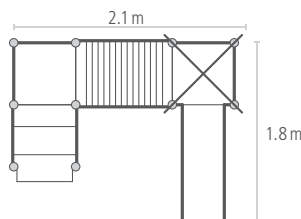

Knightsbridge with balcony
blue carpet **G833 £1,760**
warm sand carpet **G838 £1,760**

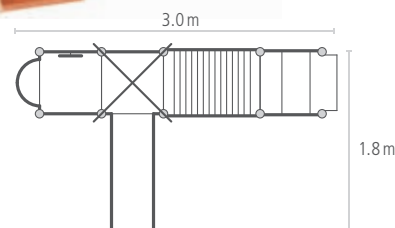

"The billy goats got their bridge,
but we didn't forget the troll.
There's a cosy space under the
bridge with mirrors on both sides."

Martin Huleatt

Community Playthings trainer



**10-Year
Warranty**

Mole hole

Up, through and down. Again and again. Tunnels are for crawling through – but you can crawl under this one too.



Mole hole with slide
blue carpet **G850 £1,308**
warm sand carpet **G855 £1,308**

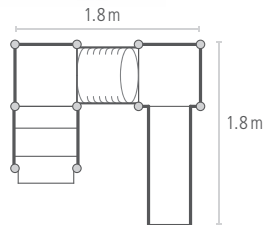

Mole hole with ramp
blue carpet **G851 £1,456**
warm sand carpet **G856 £1,456**

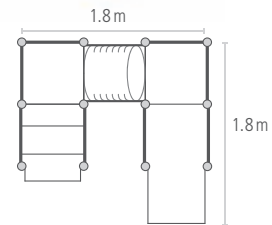

Gnome home

Gnomes don't live in tunnels – they have houses. Up the stairs, across the dunes, through the tunnel and you're home.



Gnome home with slide
blue carpet **G852 £1,578**
warm sand carpet **G857 £1,578**

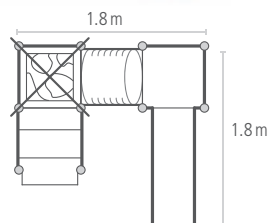

Gnome home with ramp
blue carpet **G853 £1,726**
warm sand carpet **G858 £1,726**

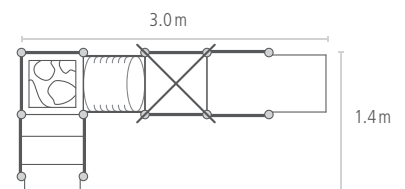

"Why do children love to crawl through tunnels? We don't know, but they do."

Jake Barth
Nursery gym design team



**Tool-free
assembly**

Windsor

A royal castle or a pirate ship? Wave to the crowds from the balcony, then down the slide, up the stairs and sail the seven seas.



Windsor with terrain
blue carpet **G840 £1,598**
warm sand carpet **G845 £1,598**

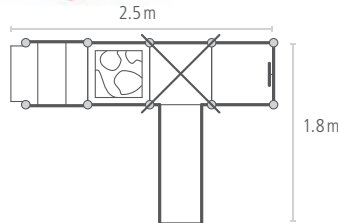

Windsor with balcony
blue carpet **G841 £1,628**
warm sand carpet **G846 £1,628**

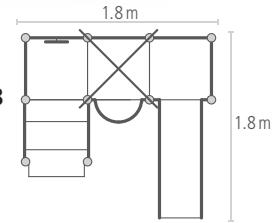

Tower bridge

London, Middle Earth or your nursery? These two towers will transform your room with elegance.



Tower bridge
blue carpet **G842 £2,478**
warm sand carpet **G847 £2,478**

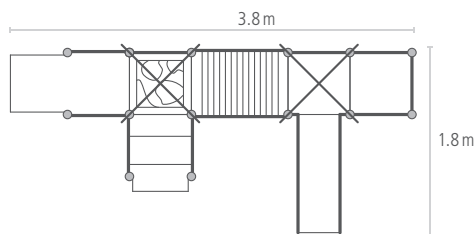

Tower bridge with balcony/steering
blue carpet **G843 £2,553**
warm sand carpet **G848 £2,553**

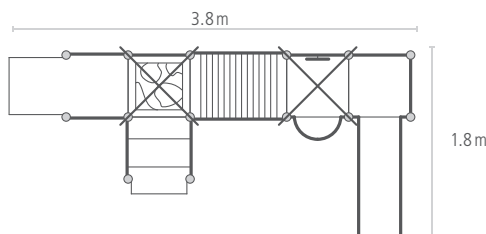

“Try using fabrics to extend your children’s play. Today the tower is a fishing boat, tomorrow a glittering fairy palace.”

Melody Neal
Nursery teacher



You can't beat playing outdoors



Children are constantly moving. Movement is how they learn their relation to the surroundings and develop co-ordination of body and brain. Young children develop their balance through all kinds of action, including sliding and bouncing. They have a deep biological drive for such experiences.

Children should spend as much time outdoors as possible. However, when children need to be inside, we must create an indoor landscape that includes some of the action, up-and-down challenges, and tactile variety that the outdoors provides. The Nursery gym offers such a movement environment.

Jan White
Outdoor play consultant

Cosy spaces too



Some people seem surprised that we incorporated cosy spaces in a piece of active-play equipment. Although I'm not a teacher, I am a father. As we worked on the nursery gym design, I often thought of my own young son. When he learned to walk, he was so pleased with himself and was always setting off on exciting expeditions. However he kept looking back at mum or me. It was like his security in our nearness empowered him to explore and investigate. So I realised that toddlers need both adventure and nurture. We hope this nursery gym will foster both.

Johann Arnold
Nursery gym design team

"Once a baby is mobile he needs
above all to be allowed to explore
so that he can see the world in a
new and different way."

People under Three
Elinor Goldschmied, Sonia Jackson





Tool-free assembly

You can build or reconfigure your Nursery gym without using any tools. It's easy to move panels around to suit your needs.



More on the web

Find further information and download the product guide with more layout options at: www.communityplaythings.co.uk/ng



Removable gate

Every slide comes with a gate, but this additional gate can close off the top of a ramp or stairs when playtime is over.

Gate G888 £30

Ready to order?

You can place your order online at www.communityplaythings.co.uk, email sales@communityplaythings.co.uk or phone 0800 387 457.



Knightsbridge with balcony G838



Robertsbridge, East Sussex TN32 5DR
 Telephone: 0800 387 457
 Fax: 0800 387 531
www.communityplaythings.co.uk

Prices valid until 31 December 2012

© 2011 by Community Products (UK) Limited